



## Designed meticulously to offer homes to the urbanite

At Pragathi Amber, we believe this journey begins at home. Inspired by premium design coupled with a contemporary style, Amber is a masterpiece to behold. It is located in Electronic City Phase 2, a well developed residential area surrounded by affluent industrial parks and IT companies.

Towering as high as fourteen storeys, Pragathi Amber will offer 187 perfectly crafted 11 variants to choose from Studio, 2BHK and 3BHK.

Pragathi Amber promises to create an ideal urban experience in harmony with nature while enhancing the way you live. All we wish is that you live life - wholly and simply.

Pragathi Amber is developed by SLV CONCRETES, a highly experienced company that has successfully completed over 5 lakh sq.ft of residential projects in Bangalore. The Company is backed by talented and enthusiastic team of professionals who work towards achieving the company's objectives.



*Created to live in luxury...priced to affordable*

Put your feet up or entertain in the understated elegance of your living space. You place your choice of decorations on the sill but panoramic view from your balcony may be the only decorative you will need.



# *Represents the art of peaceful living*

Pragathi Amber home os one of the most impressive luxury of premium living, situated in the fast-developing IT Hub of bangalore - Electronic City. It is in close proximity to modern conveniences, premium healthcare facilities and educational institutions.



ELECTRONIC CITY  
Toll Gate 1.5 Km

BIOCON  
2.0 Km

BROOKFIELD SCHOOL  
2.0 Km

VIMALAYA HOSPITAL  
2.5 Km

FORUM MALL  
14.0 Km

M.G ROAD  
17.0 Km

EBENEZER  
INTERNATIONAL SCHOOL 1.0 Km

CHAITANYA INTERNATIONAL  
SCHOOL 2.0 Km

NARAYANA HRUDAYALAYA  
4.0 Km

INTERNATIONAL  
AIRPORT 49.5 Km



A modern high-rise apartment building at dusk. The building is illuminated from within, showing balconies and windows. In the foreground, there are palm trees and a paved area with a white car parked. The sky is a mix of blue and orange from the setting sun.

# *The good & healthy living*

Amber home welcomes you to a realm of freedom and grandeur. Luxurious and spaciouly laid out, your home is thoughtfully built to mirror your aspirations.



The image shows a modern, multi-story apartment building at night. The building has a light-colored facade with balconies and large windows. In the foreground, there is a swimming pool with a blue tiled edge and a metal staircase. The pool is surrounded by a dark deck with two glowing lanterns. In the background, there is a lounge area with white lounge chairs, blue umbrellas, and a glass-enclosed area. The building's balconies have decorative metal screens with a geometric pattern. The overall scene is illuminated by warm lights from the building and the pool area.

## *Unparalleled Modernity*

Welcome to your PARADISE.

A place where you can lounge with the stars, indulge your love for the finer things in life, with a lavish pool offering you a stunning view.



# *A compliment to the idea of urban - living*

*A harmonious work-life balance is crucial to any urbanite, where one spends quality time with family. The amenities at Amber ensure that one can priorities work as much as leisure.*

Gym with Spa  
Swimming Pool & Toddler's Pool  
Children's Play Area  
Meditation Space  
Organic Garden  
Yoga Room  
Multipurpose Room  
Table Tennis  
Snooker  
Elders's Park  
Indoor Board Games  
Multipurpose Court  
Tennis Court  
Jogging Track  
Half Basket Ball Court  
Barbeque Deck  
Roof-Top Lounge  
Amphitheater  
Rainwater Harvesting





## *Opulent & Lavish*

*Every square foot at Amber is built to understand you and your needs. From thoughtful play areas for children, to a fully-equipped recreation centre, an elders corner and even tennis. You'll never be short of things to do.*





An artist's perspective rendering of the Pragathi Amber apartment complex at dusk. The image shows four tall, modern apartment towers with a white and blue facade. The balconies are illuminated from within, and the building's exterior is lit with warm, golden light. In the foreground, there is a large swimming pool with a blue and white tiled deck, surrounded by lush greenery and trees. To the right of the pool, there is a basketball court and a small sports field. The sky is a mix of blue and purple, with some clouds. The overall atmosphere is one of luxury and modern living.

# *Nature preserve for luxury living*

*Created for the experts,  
Pragathi Amber is an  
uber-exclusive community  
of like-minded individuals  
who share a passion for the  
good life. Indeed, for those  
who seek nothing short  
of the unusual.*

*Pragathi Amber is a lifestyle  
reserved for the inspired.*



## *Extensive interior spaces*

*More natural light only means less artificial light.  
We've incorporated large sliding windows to allow  
ample amount of warmth, fresh air and light to pour  
into your home and life.*





## *Spacious Bedroom*

*A morning spent lazing in bed after a long peaceful sleep is everyone's dream. the spacious and calmness of the bedroom will allow you to make it come true.*





*Your kitchen ... Your way...  
More room to cook in*

*Let your culinary dreams take flight to embark  
on a journey of fun and frolic with family.  
Carefully planned modern and stylish kitchen to  
accommodate absolutely everything you'll need.*





*Balcony to enjoy the outdoor ambiance. A personal patch of green, where you can let the breeze, the sunlight and the birds chirp, sweep across you.*

*Being at your personal space*





# Floor Plans

Amber offers carefully designed floor plans that provide maximum space utilisation without compromising on open spaces

1<sup>st</sup>, 2<sup>nd</sup>, 3<sup>rd</sup>, 4<sup>th</sup>, 7<sup>th</sup>, 8<sup>th</sup>, 11<sup>th</sup> & 12<sup>th</sup>  
Floor Plan

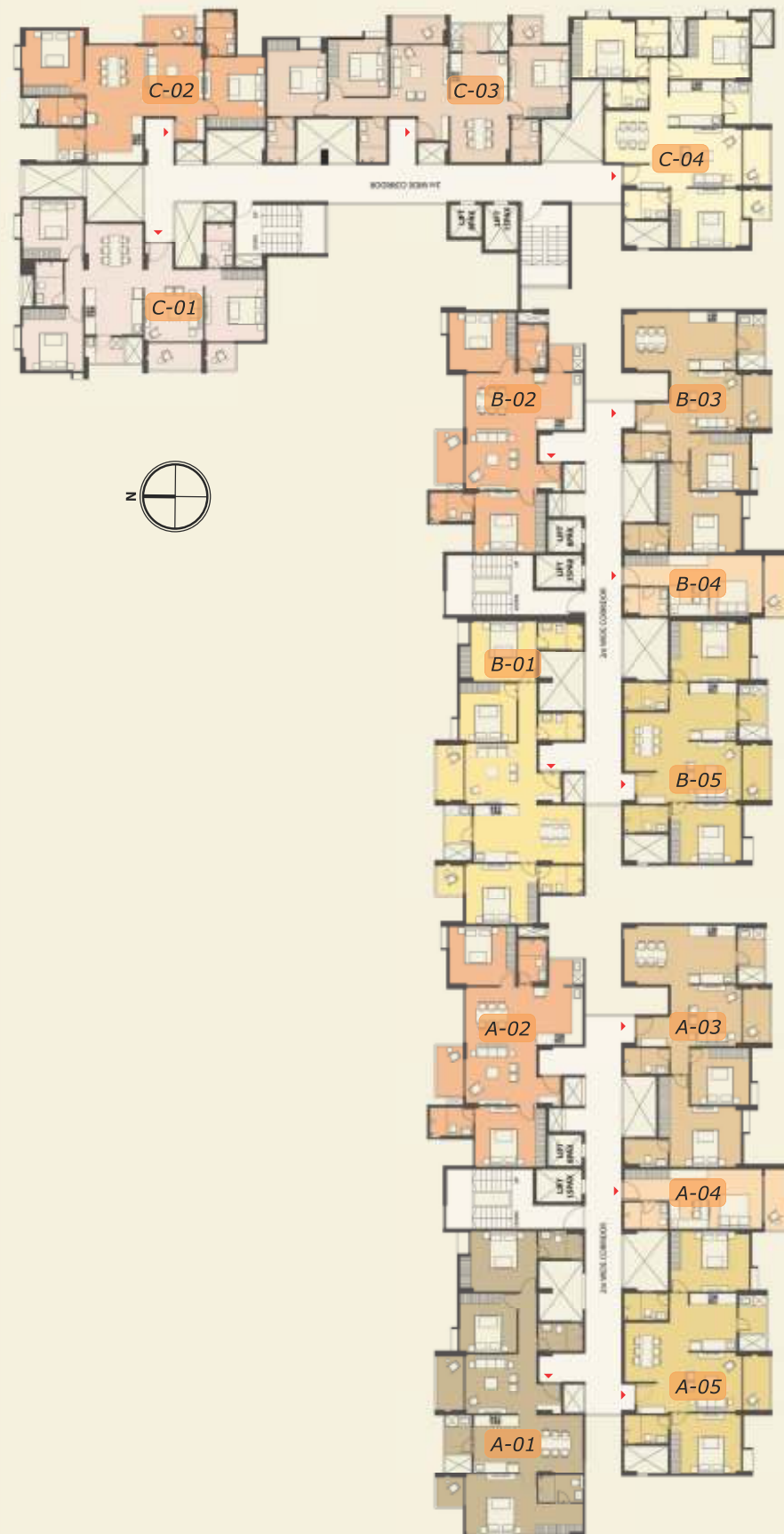

5<sup>th</sup>, 9<sup>th</sup> & 13<sup>th</sup>  
Floor Plan

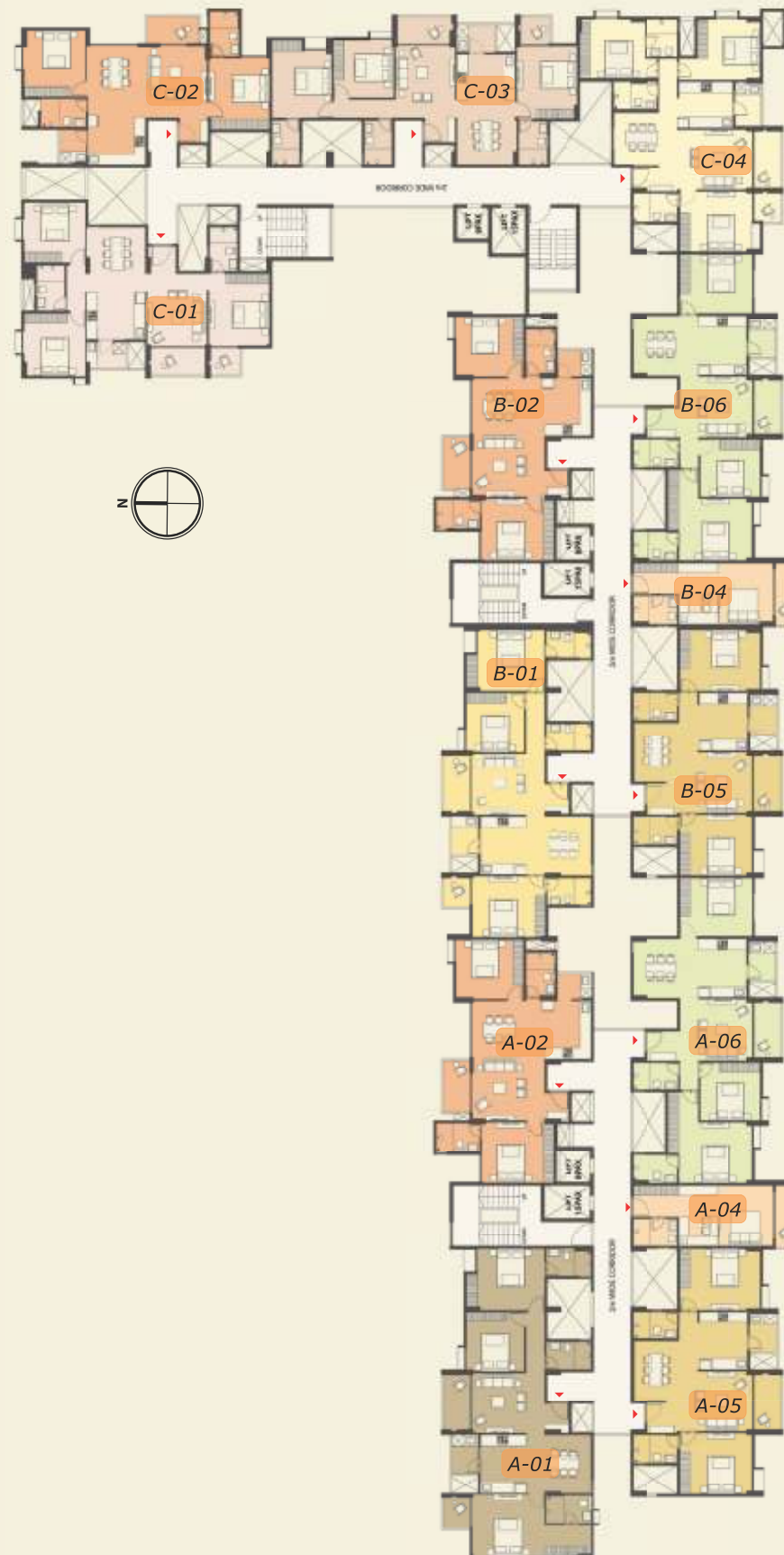

6<sup>th</sup>, 10<sup>th</sup> & 14<sup>th</sup>  
Floor Plan

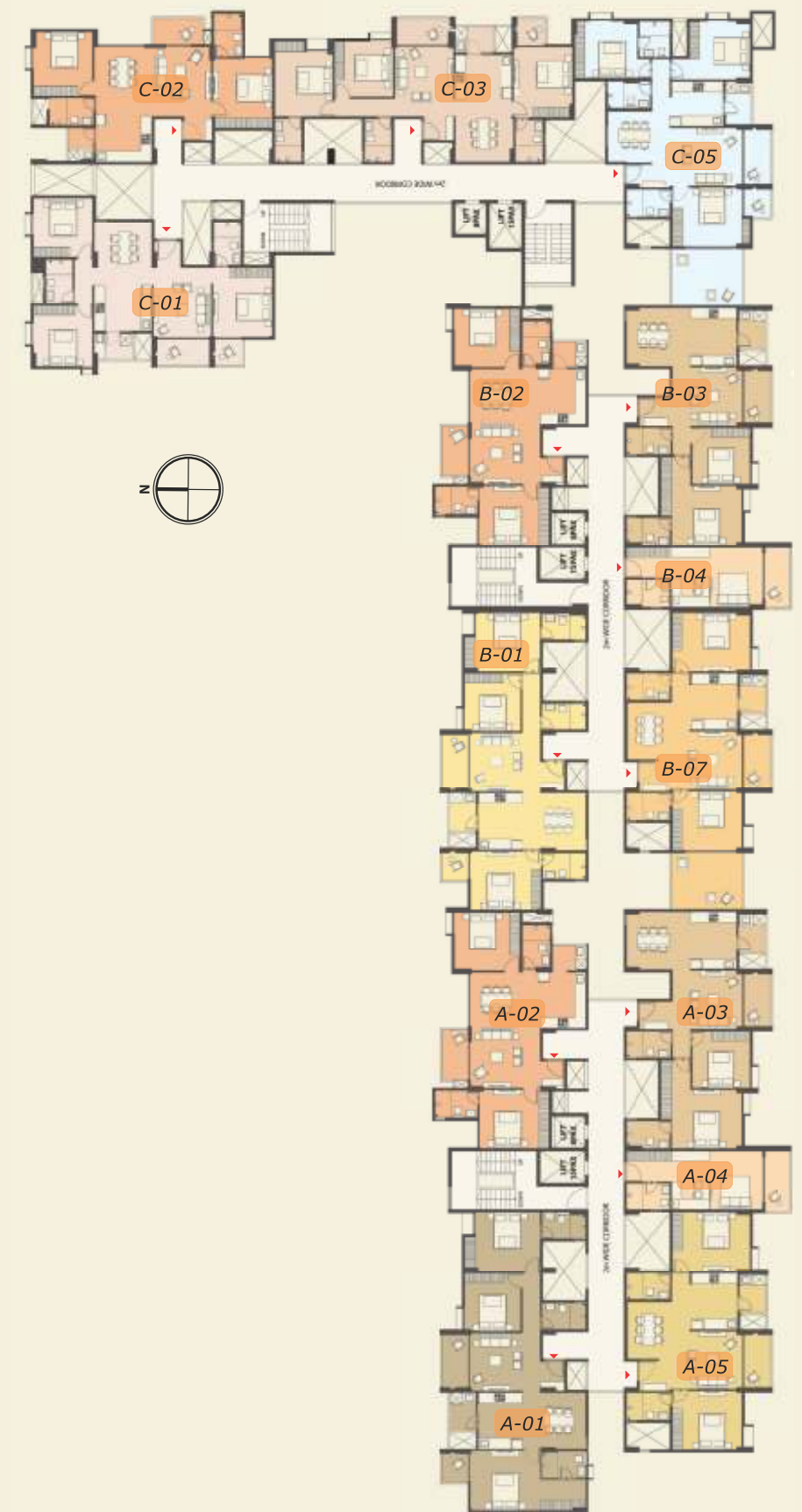



**Unit A 01 - Type 3B 3T**  
**Area 1560 sq. ft**  
**East facing**



FOYER	4'-9" X 4'-6"	MASTER BEDROOM	11'-0" X 13'-0"
LIVING	10'-9" X 13'-0"	DRESS	5'-6" X 8'-6"
BALCONY	9'-9" X 5'-0"	MASTER BEDROOM TOILET	5'-0 X 8'-0"
DINING	10'-6 X 11'-9"	MASTER BEDROOM BALCONY	5'-3 X 5'-0"
KITCHEN	10'-6 X 8'-3"	BEDROOM 1	10'-9" X 10'-3"
UTILITY	7'-0" X 5'-0"	COMMON TOILET	5'-0"X 8'-0"
TOILET	5'-0 X 8'-0"	BEDROOM 2	11'-" X 12'-0"

**Unit C 04 - Type 3B 3T**  
**Area 1500 sq. ft**  
**North facing**



FOYER	4'-3" X 8'-3`"	MASTER BEDROOM	11'-0" X 13'-0"
LIVING	10'-9" X 13'-3"	MASTER BEDROOM TOILET	5'-0 X 8'-0"
BALCONY	9'-9" X 5'-0"	BEDROOM BALCONY	5'-3" X 5'-0"
DINING	9'-6 X 11'-6"	BEDROOM 1	10'-9"X 11'-3"
KITCHEN	8'-3v X 9'-9"	COMMON TOILET	5'-0" X 8'-0"
UTILITY	7'-6" X 5'-0"	BEDROOM 2	10'-6" X 11'-6"
		TOILET	6'-9" X 5'-6"

**Unit C 03 - Type 3B 3T**  
**Area 1490 sq. ft**  
**North facing**



FOYER	4'-6" X 5'-3"	MASTER BEDROOM	11'-0" X 13'-0"
LIVING	10'-9" X 13'-0"	MASTER BEDROOM TOILET	8'-0 X 5'-0"
BALCONY	9'-9" X 5'-0"	BEDROOM BALCONY	5'-0" X 5'-3"
DINING / KITCHEN	20'-0 X 10'-6"	BEDROOM 1	10'-3"X 10'-9"
UTILITY	5'-0" X 7'-0"	COMMON TOILET	8'-0" X 5'-0"
		BEDROOM 2	10'-9" X 12'-0"
		TOILET	8'-0" X 5'-0"

**Unit C 01 - Type 3B 2T**  
**Area 1400 sq. ft**  
**East facing**



FOYER	4'-9" X 4'-6"	MASTER BEDROOM	13'-0" X 11'-0"
LIVING	13'-0" X 10'-9"	MASTER BEDROOM TOILET	8'-0 X 5'-0"
BALCONY	5'-0" X 9'-9"	BEDROOM BALCONY	5'-0" X 5'-3"
DINING	11'-9 X 10'-6"	BEDROOM 1	11'-3"X 11'-0"
KITCHEN	8'-6" X 10'-6"	COMMON TOILET	5'-0" X 8'-0"
UTILITY	5'-0" X 7'-0"	BEDROOM 2	11'-0" X 11'-0"



Unit A 03 & B 03 - Type 2B 2T  
Area 1250 sq. ft  
North facing



FOYER	5'-0" X 6'-0"	MASTER BEDROOM	11'-0" X 13'-0"
LIVING	11'-0" X 13'-0"	MASTER BEDROOM TOILET	5'-0 X 8'-0"
BALCONY	9'-6" X 5'-0"	BEDROOM 1	10'-6"X 10'-9"
DINING	10'-9 X 11'-6"	COMMON TOILET	5'-0" X 8'-0"
KITCHEN	10'-6 X 8'-9"		
UTILITY	7'-0" X 5'-0"		

Unit A 02 & B 02 - Type 2B 2T  
Area 1165 sq. ft  
East facing



FOYER	4'-9" X 4'-6"	MASTER BEDROOM	11'-0" X 13'-0"
LIVING / DINING	21'-6 X 13'-0"	MASTER BEDROOM TOILET	5'-0" X 7'-9"
BALCONY	9'-3" X 5'-0"	BEDROOM	10'-9 X 12'-0"
KITCHEN	10'-3 X 8'-6"	BEDROOM 2	10'-9 X 12'-0"
UTILITY	5'-0 X 6'-6"	COMMON TOILET	5'-0"X 7'-9"

Unit A 05 & B 05 - Type 2B 2T  
Area 1220 sq. ft  
North facing



FOYER	5'-6" X 6'-0"	MASTER BEDROOM	11'-0" X 13'-0"
LIVING	10'-9" X 11'-3"	MASTER BEDROOM TOILET	5'-0 X 8'-0"
BALCONY	9'-9" X 5'-0"	BEDROOM 1	11'-0" X 14'-3"
DINING	10'-6 X 10'-0"	COMMON TOILET	5'-0"X 8'-0"
KITCHEN	10'-6 X 9'-0"		
UTILITY	7'-0" X 5'-0"		

Unit A 04 & B 04 - Type Studio  
Area 470 sq. ft  
North facing



FOYER	5'-6" X 8'-3"
BEDROOM / KITCHEN	10'-9" X 17'-0"
BALCONY	11'-3" X 4'-9"
TOILET	5'-0 X 8'-0"



## SPECIFICATIONS

RCC framed structure with solid block masonry with anti-termite treatment for entire plinth

## FLOORING

Living/Dining/Kitchen

Foyer/Bedroom I Vitrified tiles

Master Bedroom I Laminated wooden flooring

Balcony/Utility/Toilets I Premium designer full body tile on wall and floor

## KITCHEN

Premium ceramic tiles above counter

Granite counter with stainless steel sink

Long body swivel bibcock for sink

Provision for water heater and water purifier

Designer Kitchen\*

## UTILITY

Washing machine point and dishwasher inlet and outlet Cloths line\*

## TOILET

High quality single lever faucets for washbasin

EWC and washbasins of good quality

High quality single lever diverter

Health faucets and flush valve in all toilets

Frameless shower cubicle in master bedroom\*

Towel rod\*

Toilet paper holder\*

Soap tray / Robe hook\*

Mirror\*

## DOORS

Entrance door to the flat, with both sides veneer, fitted on teakwood frame.

Bedroom doors with hardwood frame

Masonite shutters resin coated and paint finished

## WINDOWS

3 Track sliding UPVC windows with mosquito mesh

Ventilators: UPVC with glass louvers

## PAINTING

Exterior: Texture finish with exterior emulsion weatherproof paint

Internal Ceilings: Distemper paint

Internal Walls: Acrylic emulsion paint

Common Area: Emulsion paint

## ELECTRICAL

Modular switches with concealed copper wires

Power backup

## LIFTS

8 passenger capacity lift

Stretcher lift / Service lift

## FIRE FIGHTING SYSTEM

## HOME AUTOMATION\*

## INTERNET\*

## TELECOM\*

## DISH TV\*

## GAS PIPING\*



Project Developed By



SLV CONCRETES

Architecture



PMC



Project Approved by

